

RESISTO PRODUCTS INSTALLATION GUIDE FOR CONSTRUCTION DETAILS

Each solution has its colour.

ROOFS

FOUNDATIONS

VARIOUS WATERPROOFING

CONSTRUCTIONAL DETAILS

Make the right choice!



3

VARIOUS AIR BARRIER AND WATERPROOFING JOBS

Time-tested premium quality products

Whether you're building or renovating, RESISTO products offer effective solutions for preventing and eliminating water leaks.

Manufactured by SOPREMA, RESISTO products are the benchmark for residential waterproofing.

Warranty

RESISTO products are guaranteed against manufacturing defects and are suitable for the uses for which they are designed. SOPREMA'S responsibility under this warranty is limited to the replacement of defective RESISTO products.



CUSTOMER SERVICE

1 877 478.8408

www.resisto.ca

AR-163 • PRINTED IN CANADA - 022009





RED ZONE

AIR BARRIER AND WATERPROOFING

Say goodbye to air infiltrations and water leaks, and the tricks that *Mother Nature* can pull with RED ZONE AIR BARRIER & WATERPROOFING MEMBRANE.

RED ZONE is designed for a wide range of residential uses. It's great for sealing joints and openings in brick, wood, concrete, and metal surfaces. It provides maximum protection by ensuring the continuity of air barrier and waterproofing systems in all exposed areas.

REQUIRED TOOLS

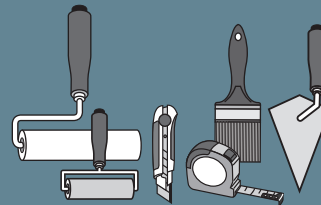

Do not use foam rollers or plastic trays for RESISTO EXTERIOR PRIMER.

REQUIRED PRODUCTS



Minimum application temperature for RESISTO H₂O PRIMER is 41°F (5°C).

MULTIPURPOSE IMPORTANT

This membrane must be covered with a finishing material. For applications where the membrane must remain exposed, use RESISTO MULTIPURPOSE ALUMINUM WATERPROOFING MEMBRANE.

APPLICATION TEMPERATURE

- Minimum application temperature
Regular grade : 50 °F (10 °C)
"Winter" grade : 14 °F to 50 °F (-10 °C to 10 °C)

* RESISTO EXTERIOR PRIMER (solvent-based) is strongly recommended at temperatures between 50 °F and 32 °F (10 °C and 0 °C).

RED ZONE AIR BARRIER & WATERPROOFING

MEMBRANE

SELF-ADHESIVE ELASTOMERIC



RED ZONE AIR BARRIER & WATERPROOFING MEMBRANE

is a 40-mil-thick (1.0 mm) self-adhesive membrane composed of elastomeric bitumen and trilaminate woven polyethylene. It is designed as an air/vapour barrier for exterior walls and must be covered with sheathing or other finishing material. It has an easy-to-remove, silicone-treated release sheet on the self-adhesive side.

The RED ZONE AIR BARRIER & WATERPROOFING MEMBRANE is mostly used as an air/vapour barrier for door and window frames, brick flashing, roof flashing, and other jobs.

BENEFITS

- Installs easily on most brick, wood, metal, and concrete surfaces requiring protection
- Eliminates drafts and water leaks
- High tear and puncture resistance
- Requires no special tools

RECOMMENDED USES

- Exterior walls (except foundations)
- Door and window frames
- Around various openings such as sunrooms, skylights, etc.
- Brick flashing, roof flashing, and other construction details
- Lap joints (between strips of RESISTO WATERPROOFING MEMBRANES installed without overlaps)

VARIOUS AIR BARRIER & WATERPROOFING JOBS

The RED ZONE AIR BARRIER & WATERPROOFING MEMBRANE installs easily on most surfaces with joints, cracks, stable openings, etc.

- Provides a continuous vapour barrier indoors and an air barrier outdoors
- Door and window frames
- Dormers, skylights, and sunrooms
- Chimney bases
- Unexposed flashing
- Panel joints
- Wood/concrete spacers

APPLICATION METHOD

APPLICATION CONDITIONS

Apply RED ZONE AIR BARRIER & WATERPROOFING MEMBRANE to clean, dry surfaces free of oil, grease, and residues. Priming may be advisable in certain cases. Use at 50 °F (10 °C) or above.

**OSB, wood, concrete, drywall, and fibreglass surfaces must always be primed.*

SUBSTRATE

- Installs easily on most brick, metal, and concrete surfaces requiring protection.

APPLYING THE RED ZONE AIR BARRIER & WATERPROOFING MEMBRANE

- Clean and dry the surface, as required.
- Use a brush or roller to apply a coat of RESISTO PRIMER.

Drying time

½ hour to 3 hours, depending on application conditions. The drying time can vary according to the ambient temperature and the thickness applied, but also according to the type of substrate.

Coverage

EXTERIOR PRIMER:
1L covers 32 to 55 ft² (3 to 5 m²)

H₂O PRIMER:
1L covers 32 to 96 ft² (3 to 9 m²)

Coverage may vary depending on the permeability of the substrate.

- The primer is dry when sticky but not messy when touched.
- On a rough surface (e.g., shingles), RESISTO ELASTOMERIC SEALER should be used to enhance the adherence.
- Install the membrane while following the subsequent steps.
- Cut the membrane and carefully position it on the surface to be covered.
- Peel back the release sheet 10 cm (4 in) and affix the membrane as positioned.
- Continue peeling back the release sheet, rolling it up.
- Press down on the membrane with a small, hard roller to increase adherence.

GENERAL INFORMATION WATERPROOFING CORNERS (VARIOUS WATERPROOFING JOBS)

When corners are to be protected with a RESISTO MEMBRANE, gussets (a small piece of membrane) must be installed first to waterproof the corners.

IMPORTANT

This membrane is not designed to be exposed to UV rays and must be quickly covered with finishing material.

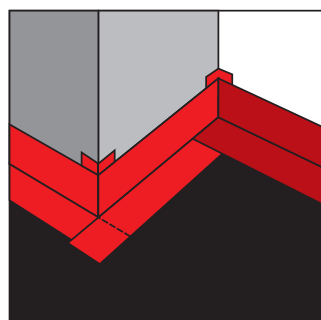
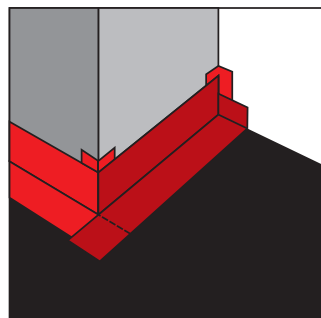
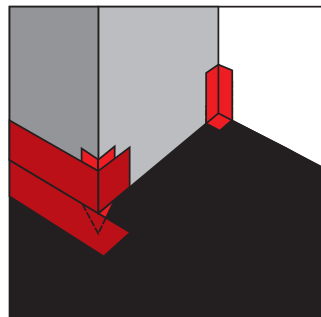
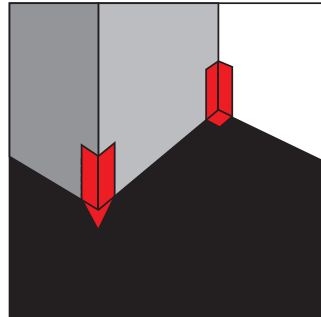

CONSULT OUR INSTALLATION GUIDES FOR WINDOWS ON THE FOLLOWING PAGES!

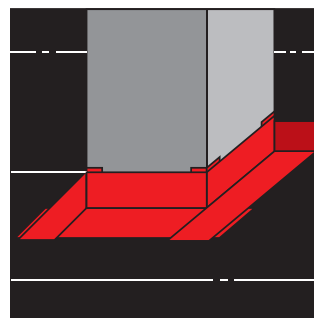
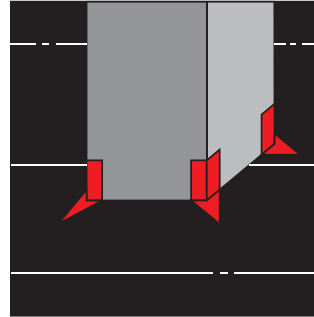

RED ZONE CornerGuard

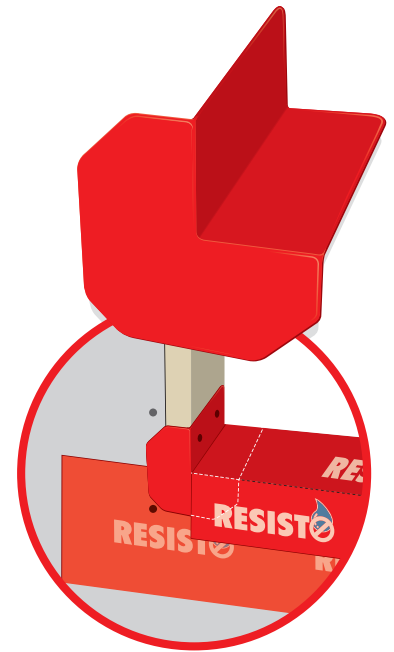

RED ZONE CORNER GUARD

is designed to flash and protect one of the most critical areas, the joints between the sill and jamb.

The design of the corner guard allows for fast, easy mechanical fastening to 2" x 4" and 2" x 6" wood or metal studs using screws or nails.

BENEFITS

- SAVES TIME
- HELPS REDUCE COSTLY cutting, folding, and caulking MISTAKES when waterproofing complex details.

RECOMMENDED USES

- Door frames
- Window frames



INSTALLING THE RED ZONE AIR BARRIER & WATERPROOFING MEMBRANE ON A WEATHER RESISTIVE BARRIER MEMBRANE



In cases where the weather resistive barrier membrane (WRB) and window have already been installed, apply the RED ZONE membrane directly on the WRB and window tabs, starting with the sill, the jambs, and finishing with the header piece.

Press down firmly on the RED ZONE membrane using a small roller to ensure proper adhesion.

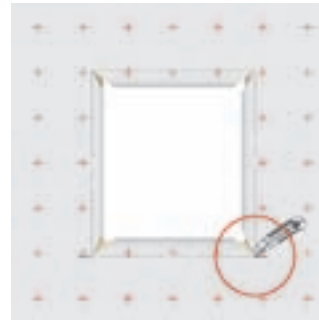

- 1**
- Cut strips of WRB to cover the sill, jambs, and header of the window.
 - Fix in place, leaving the header piece unfastened for the moment.
 - Make 2.5 in (6 cm) horizontal cuts in the WRB on both sides of the sill.

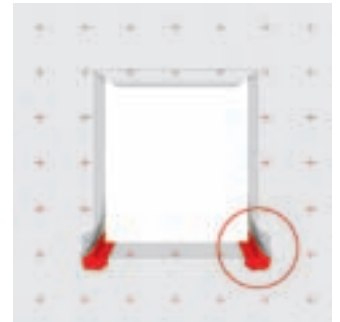

- 2**
- Insert the **RESISTO RED ZONE CORNER GUARDS** underneath the WRB on both sides of the sill to prevent leaks.

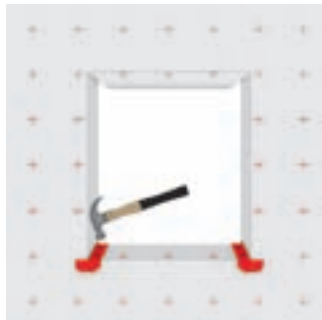

- 3**
- Mechanically fasten the **RED ZONE CORNER GUARDS** in place.

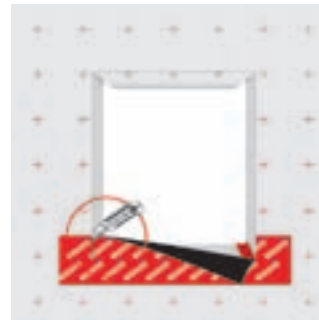

- 4**
- Install bands of **RED ZONE** membrane, starting with the sill. Cut on both sides of the opening.

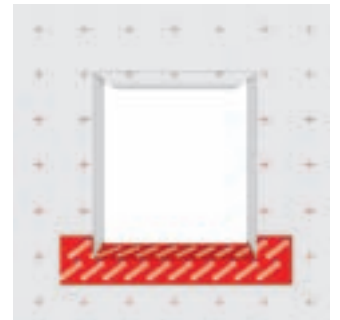

- 5**
- Adhere the **RED ZONE** membrane to the sill.

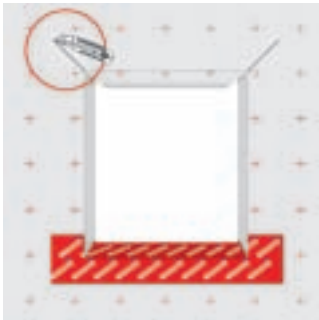

- 6**
- Make 45° cuts at both corners of the header WRB and lift up.

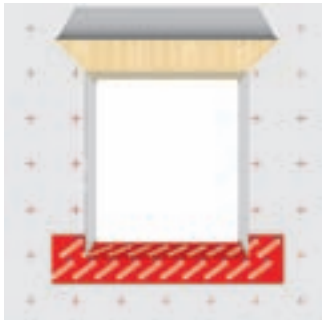

- 7**
- Temporarily adhere the uplifted header WRB to facilitate installation of **RED ZONE** header membrane.



- 8**
- Install the window in the opening.



- 9**
- Cover both jambs with a band of **RED ZONE** membrane.



- 10**
- Cover the header with a band of **RED ZONE** membrane.



- 11**
- Fold the header WRB back in place.



- 12**
- Cover the 45° cuts in the header WRB with bands of **RED ZONE** membrane.



- 13**
- Seal the header with a band of **RED ZONE** membrane to ensure the continuity of the air barrier.

INSTALLING THE RED ZONE AIR BARRIER & WATERPROOFING MEMBRANE BEFORE A WEATHER RESISTIVE BARRIER MEMBRANE



Firmly press down on the RED ZONE membrane with a small roller to ensure good adhesion.



1 • Clean the surface and make sure there are no nails protruding from the wall.



2 • Prime plywood, OSB, and fiberglass panels with **RESISTO EXTERIOR PRIMER** or **RESISTO H₂O PRIMER** to ensure proper adhesion.



3 • Mechanically fasten the **RED ZONE CORNER GUARDS** in place.



4 • Install bands of **RED ZONE** membrane, starting with the sill.



5 • Cut the membrane on both sides of the opening.



6 • Adhere the **RED ZONE** membrane to the sill.



7 • Install a band of **RED ZONE** membrane inside each jamb.



8 • Cover the inside of the header with a band of **RED ZONE** membrane.



9 • Cut the membrane on both sides of the opening.



10 • Adhere the band of **RED ZONE** membrane in place.



11 • Install the weather resistive barrier membrane on the wall.



12 • Install the window in the opening.



13 • Install a band of **RED ZONE** membrane on the sill.

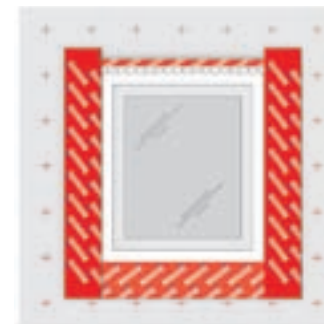

14 • Install bands of **RED ZONE** membrane on both sides of the window.



15 • Seal the header with a band of **RED ZONE** membrane.

AIR BARRIER AND WATER-PROOFING FOR MASONRY

RED ZONE AIR BARRIER & WATERPROOFING MEMBRANE

SELF-ADHESIVE ELASTOMERIC



APPLYING THE RED ZONE AIR BARRIER & WATERPROOFING MEMBRANE

- Prime the concrete and the lower edge of the wall with a RESISTO PRIMER.
- Adhere a band of RED ZONE membrane to the primed surface.
- Install the weather resistive barrier membrane, overlapping the band of RED ZONE at the bottom of the wall.



OR

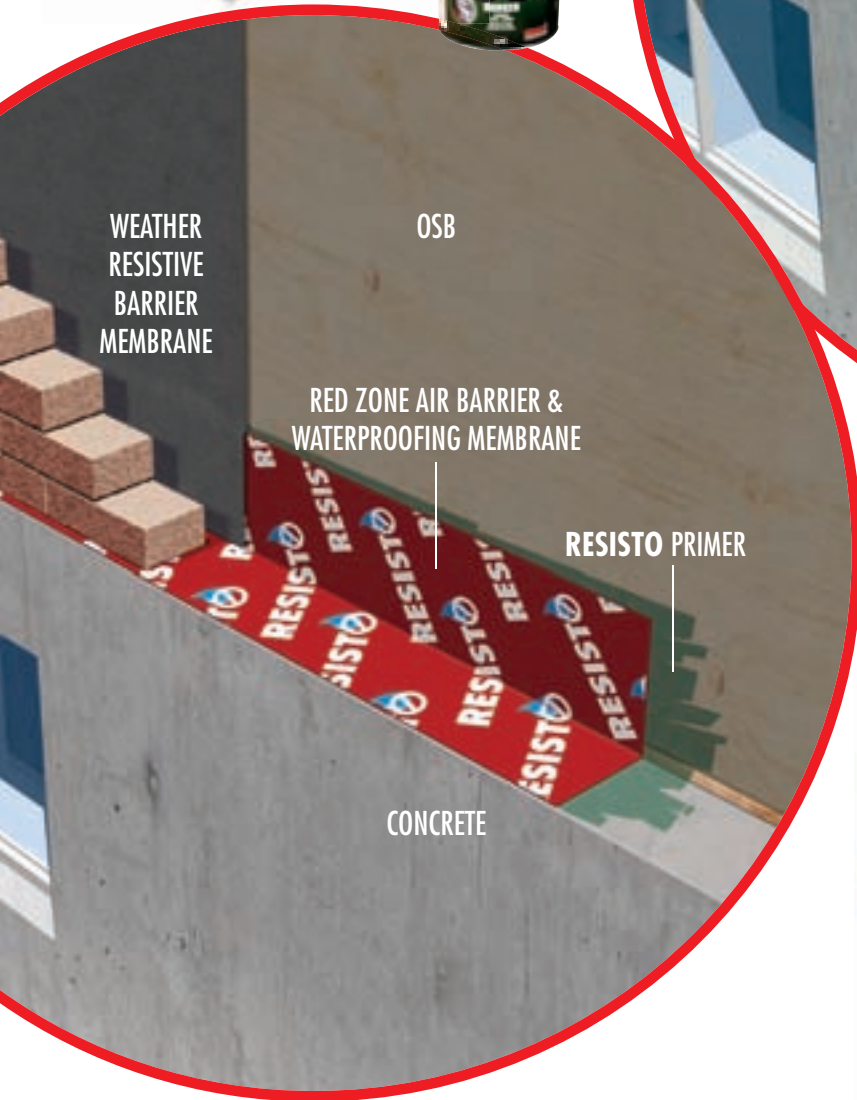
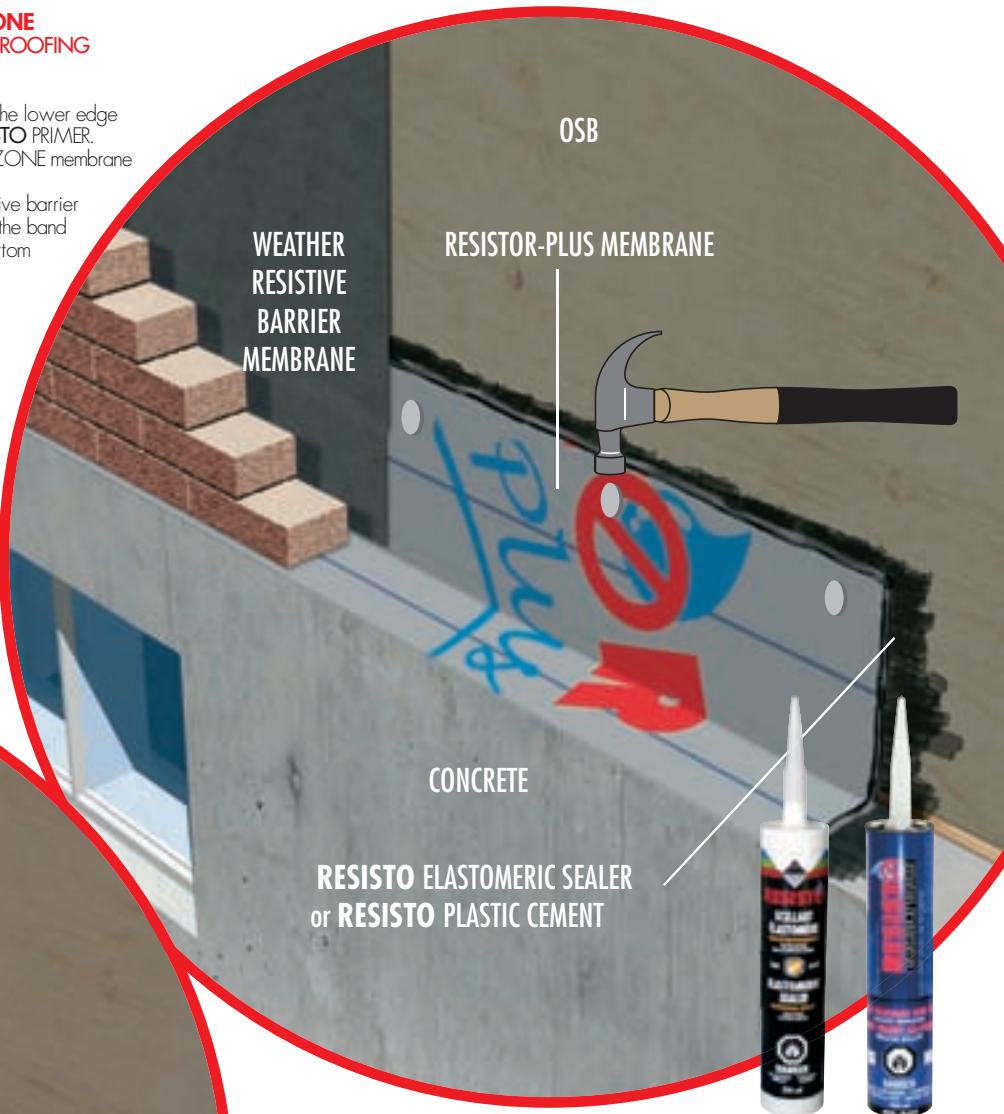

RESISTOR PLUS SYNTHETIC MEMBRANE

APPLYING THE RESISTOR PLUS MEMBRANE

- Before installing the RESISTOR PLUS membrane, apply a coat of RESISTO PLASTIC CEMENT, if necessary, to the top of the foundation and the bottom of the wall.
- Mechanically fasten the membrane in place using shingle nails.
- Install the weather resistive barrier membrane, overlapping the RESISTOR PLUS at the bottom of the wall.

